



Features

- Pass-Through Construction
- 400 Cnt. Motorized Magazine
- Interlocked Barrier Guarding
- CompactLogix PLC Controller
- Pressurized Hot Melt System
- Elevated Frame For Sanitation
- Mechanical Indexing Drive
- Programmable Limit Switches
- Casters and Leveling Legs
- Detent Jam Protection Clutch
- Case Carrier Flight Chain
- 2 HP AC Inverted Drive Motor
- Servo Product Loader
- Up To 25 Cases per Minute
- Optional Case Coding



Optional Wash-Down Series

**Servo Driven
Product Loader**

WA-25 Intermittent Motion Wraparound Casepacker



CASE ERECT AND LOAD



400 CNT. CASE MAGAZINE

Specifications

Case Range (LWD)

Minimum: 6 x 3 x 6
Maximum: 14 x 8 x 14

Packaging Material

Heavy Chipboard
F-Flute Corrugated
E-Flute Corrugated
B-Flute Corrugated
C-Flute Corrugated

Main Voltage

240VAC-3 Phase-60 Hz
480VAC-3 Phase-60 Hz (Optional)

Control Voltage

24VDC (Optional 120VAC)

Speed Range

3-25 Cases Per Minute

Air Consumption

15 CFM @ 80 PSI

Floor Space

74" Width (1880mm)
132" Length (3353mm)
78" Height (1981mm)
68 Square Feet

WA-25

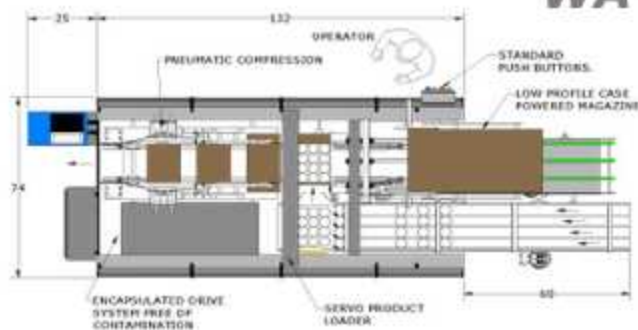

SIDE VIEW

Case Style

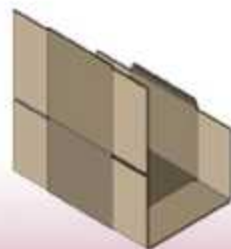

Designed to Perform

With its small footprint, the WA-25 is ideal for tight production areas. Its low-level, ergonomically-friendly horizontal magazine enables easy loading of case blanks. The standard magazine is motorized and has a 400 case capacity. The case is drawn from the magazine with vacuum operated, mechanical pick arms. The innovative design of the WA-25 ensures that timing is never lost between critical devices. Reliability and continuous production is our goal.

For further information, call one of our qualified salespersons or equipment representatives and let us put together a plan to get your company started in the direction of quality and performance.

Sales Office

Rotomotion Technology LLC
Five Mile Station, P.O. Box 190585
Boise, ID 83719 Phone: 208-639-2918
Web: www.rotomotiontechnology.com
FedEX-UPS Address: 2201 East Horse
Creek Court, Meridian, ID 83642

Factory Information

Switchback Group, Inc.
3778 Timberlake Drive
Richfield, OH 44286